

Alder Hey Children's NHS Foundation Trust

Alder Hey
Eaton Road
Liverpool
L12 2AP

Alder Hey Children's NHS Foundation Trust is situated in West Derby, Liverpool, approximately five miles east of the city centre, very close to the junction of Queen's Drive, the A5058 Ring Road and East Prescott Road, the A57.

At the end of the M62, take the right-hand lane to the Ring Road A5058 (sign-posted Ring Road A5058, Bootle, Liverpool Docks & Ferries). Proceed along this road (Queen's Drive) and turn right at the second major set of traffic lights into Alder Road. The hospital is situated approximately 300 metres on the right-hand side and is clearly signposted.

There are a number of bus services that stop near to Alder Hey. The following bus services go from Queen Square bus station in the city centre: 8, 9, 10, 10a and 10b. Other bus services in Liverpool that go to Alder Hey are the 61, 102, 111, 202 and 204.

The nearest rail station for long distance services is Lime Street Station in the city centre. You can catch a bus to Alder Hey from Queen Square bus station, a five-minute walk from Lime Street.

The nearest rail station for local services is Broad Green station. The following bus services to Alder Hey all stop near to Broad Green station: 61, 102 and 202.



DEPARTMENTAL LOCATIONS -- GROUND FLOOR

EATON RD
ENTRANCE

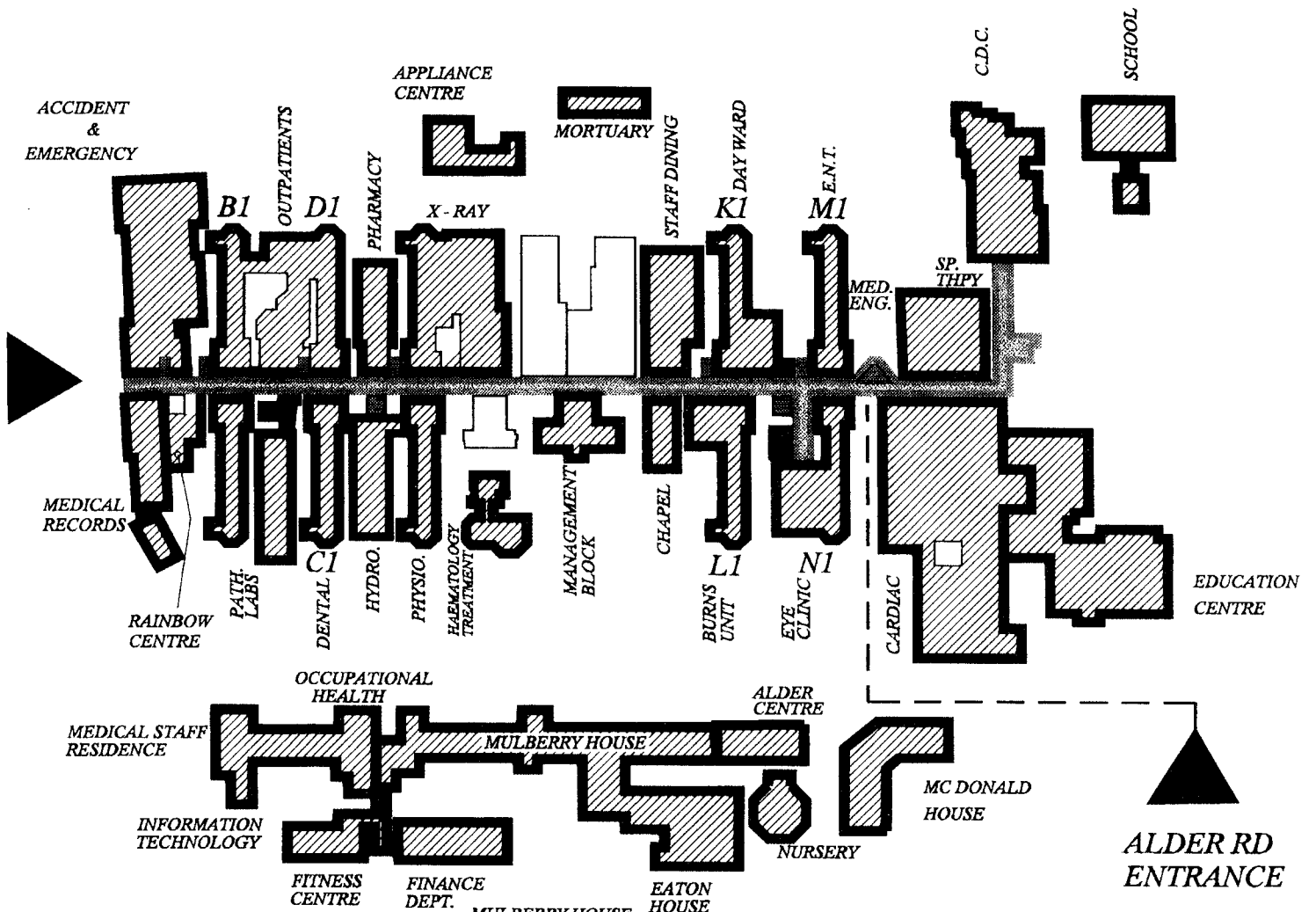

ALDER RD
ENTRANCE



ROYAL LIVERPOOL CHILDRENS N.H.S. TRUST

MULBERRY HOUSE
GROUND: CHILD MENTAL HEALTH
FIRST: COMMUNITY CHILD HEALTH
UNIVERSITY MENTAL HEALTH
PAEDIATRIC LIASON
SECOND: HUMAN RESOURCES
ACCOMMODATION
NURSE SPECIALISTS
DISTRICT NURSES

N.B.
FOR FIRST, SECOND FLOORS
AND CAR PARKING
PLEASE SEE OVER

FIRST FLOOR

N.B.
FOR MULBERRY HOUSE
PLEASE SEE OVER

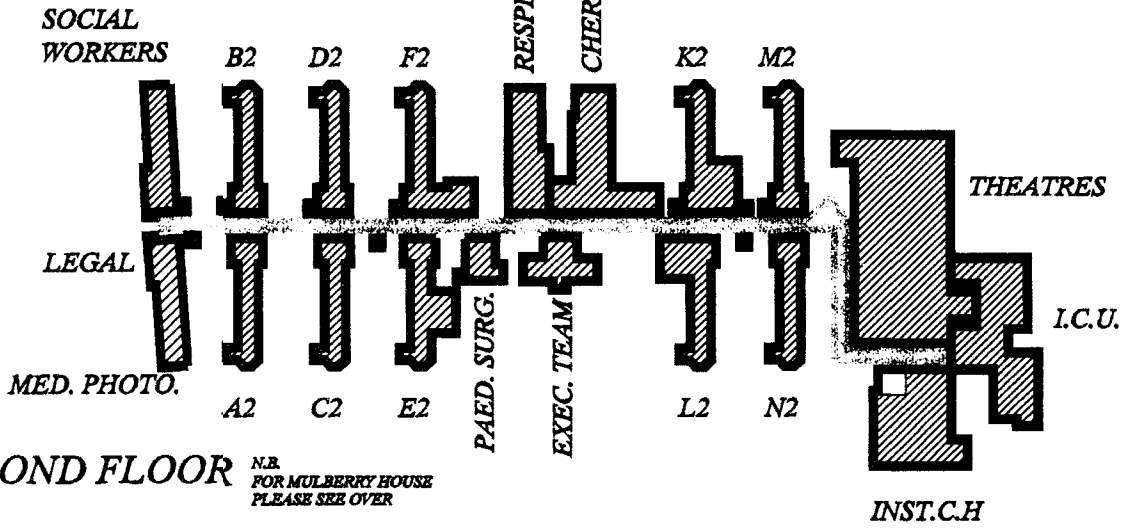

SECOND FLOOR

N.B.
FOR MULBERRY HOUSE
PLEASE SEE OVER

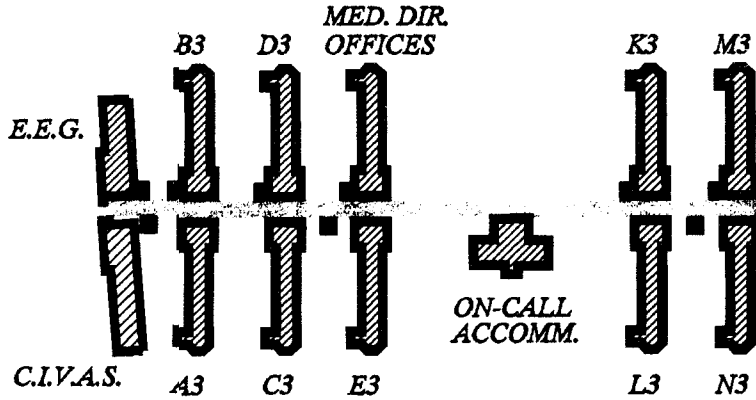

SITE PLAN

